

KNÜRR ELICON® VC / VC-E

51 to 62



MODULAR WORKSTATION SYSTEM

Whether for video surveillance, security dispatching or engineering workstations – our comprehensive product range offers optimal **solutions for a customized, ergonomic and efficient workstation.**

The **modular design** enables a wide variety of configurations and guarantees the highest degrees of flexibility. Combinations of tables can be retrofitted or modified at any time and without considerable effort.

High quality materials with extruded aluminum profiles in combination with die-cast aluminum stabilizers ensure a **maximum degree of stability and sturdiness.**

Ergonomic details simplify daily work in various situations and environments.

A **comprehensive range of accessories** completes the Knürr Elicon workstation system: flat screen holders, PC and 19-inch rack containers, workstation lighting, usable storage trays, cable routing ducts and other extras.

Knürr Elicon®VC-E

Electrical height adjustable Sit-Stand Workstation

Intelligent cable routing

Covered vertical cable routing in the side section, accessible from the inside and outside

High quality tabletops

with depths of 800 mm and 900 mm, linear or curved variants



Modular console system

Frame widths from 1200 mm to 2000 mm

In compliance with standards

Certified usability and ergonomics based on DIN 33419 / EN ISO 15537 and DIN EN 527-1.

Maximum stability

Extruded aluminum profiles with die-cast aluminum stabilizers to ensure the highest degree of stability

Standard colors:



A RAL 7035
Light gray



B Nelson Oak
wood grain

Modern design and color scheme

Base frame in RAL 9006 white aluminium, tabletop either in RAL 7035 light gray or Nelson Oak wood grain

Simple screen integration

High degree of flexibility thanks to adjustable jointed screen arms

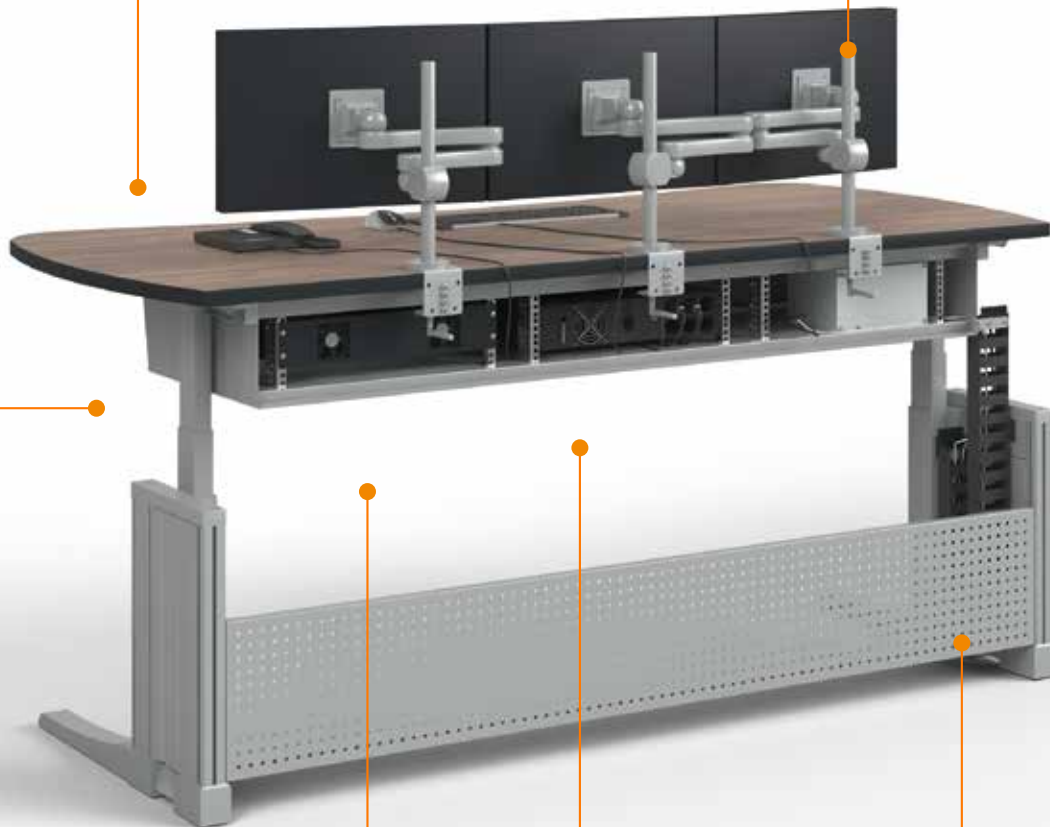

Comfortable height adjustment

Electric height adjustment from 650 to 1250 mm

Flat packaging

for reduced transport volume

Large KVM-ready technology module

with up to 3x3U 19" installation for simple and reliable installation of KVMs, socket strips, switches, etc.

Sturdy rear panel

to ensure optimal lateral stability and function as a privacy screen

Knürr Elicon®VC

Height adjustable (VC), in combination with electric height adjustment (VC-E)

Knürr Elicon VC-E Module
(Linear)

Knürr Elicon VC Module
(Linear and 90° corner)

Simple chain-linking
of electrically adjustable (VC-E) and height selectable (VC) consoles

Standard colors:



A RAL7035
Light gray



B Nelson Oak
wood grain



Height adjustable
in 20 mm increments from
640 to 760 mm

Future-proof modular design

Expand your existing table combinations, modify your current installation or supplement it with new accessories. The modular design and multi-functional T-grooves give you all the options for future upgrades.

Easy assembly

Quick and easy to assemble on site



Intelligent cable routing

Covered vertical cable routing in the side section, accessible from the inside and outside

Optional rear panels

for VC consoles guarantee a uniform design

Roomy cable troughs

Full accessibility, including optional privacy protection using front covers and plug-in rear panel

High quality energy chain

for safe and convenient routing from the VC-E side section to the cable trough

Knürr Elicon® VC-E Side Sections

Electric height adjustment

- Height adjustment range: 650 mm to 1250 mm
- Only usable in combination with Elicon VC-E Working Surfaces
- **Material / Finish**
 - Extruded aluminum profiles with die-cast aluminum stabilizers and top section
 - Steel panel covers, powder-coated
- **Color**
 - RAL9006 White aluminium
- **Supply schedule**
 - Left-hand and right-hand variants: 1 side section with lifting column, lifting column and cable duct covers
 - Center variant: 1 side section with 2 lifting columns, lifting column and cable duct covers
- **How supplied**
 - Completely preassembled

H	D	Model	Order-No	UP
590	800	Side section, left	04.265.130.7	1 unit
590	800	Side section, right	04.265.131.7	1 unit
590	800	Side section, center	04.265.132.7	1 unit



Maximum stability guaranteed!

Custom linking options between **VC-E** and **VC** modules

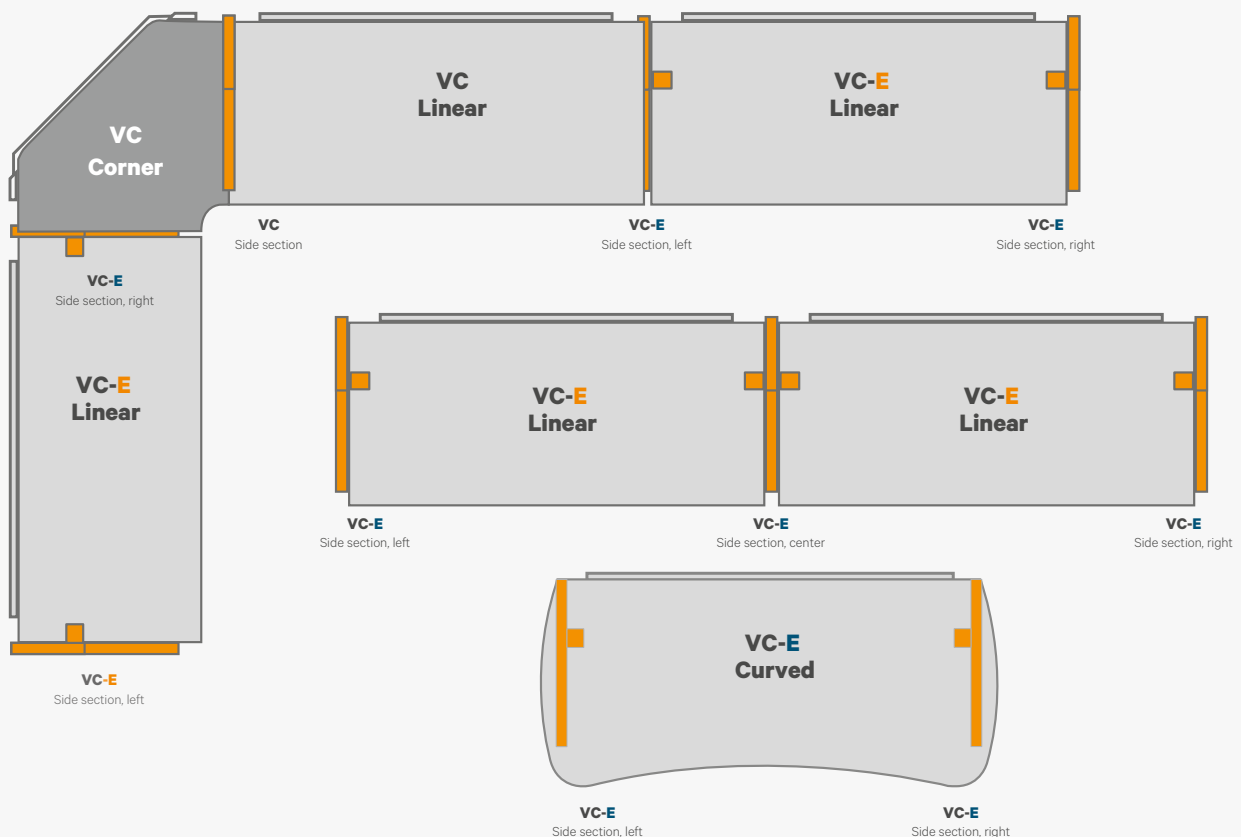

Knürr Elicon® VC-E Working Surfaces Curved

- Single table
- Height adjustment range: 650 mm to 1250 mm
- Only usable in combination with Elicon VC-E Side Sections
- **Loading capacity**
 - 1200 N (static surface load)
- **Material / Finish**
 - Tabletop: Three-layer particle board FP/Y E1 variant, fire protection class B2
 - Tabletop cover: High pressure plastic laminate (HPL)
 - Edging: ABS
 - Stabilizer, cable trough and rear panel Steel panel, powder-coated
- **Color combination**
 - Tabletop:
 - .A RAL7035 Light gray or
 - .B Nelson Oak wood grain
 - Edging: Black gray
 - Sheet metal parts: RAL9006 White aluminium
- **Supply schedule**
 - 1 working surface with KVM technology module and 19" profiles
 - 1 control unit for electrical height adjustment
 - 1 energy chain
 - 1 rear panel, bottom
- **How supplied**
 - Preassembled, flat packaging

W	D	Model	Order-no.	UP
1400	800	Curved	04.265.023.x	1 unit
1600	800	Curved	04.265.024.x	1 unit
1800	800	Curved	04.265.025.x	1 unit
2000	800	Curved	04.265.026.x	1 unit
2200	800	Curved	04.265.027.x	1 unit
1400	900	Curved	04.265.033.x	1 unit
1600	900	Curved	04.265.034.x	1 unit
1800	900	Curved	04.265.035.x	1 unit
2000	900	Curved	04.265.036.x	1 unit
2200	900	Curved	04.265.037.x	1 unit



CON20118

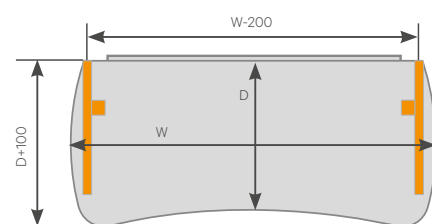

CON20119

Knürr Elicon® VC-E Working Surfaces Linear

- Single table or linked
- Height adjustment range: 650 mm to 1250 mm
- Only usable in combination with Elicon VC-E Side Sections
- **Loading capacity**
 - 1200 N (static surface load)
- **Material / Finish**
 - Tabletop: Three-layer particle board FP/Y E1 variant, fire protection class B2
 - Tabletop cover: High pressure plastic laminate (HPL)
 - Edging: ABS
 - Stabilizer, cable trough and rearpanel Steel panel, powder-coated
- **Color combination**
 - Tabletop:
 - .A RAL7035 Light gray or
 - .B Nelson Oak wood grain
 - Edging: Black gray
 - Sheet metal parts: RAL9006 White aluminium
- **Supply schedule**
 - 1 working surface with KVM technology module and 19" profiles
 - 1 control unit for electrical height adjustment
 - 1 energy chain
 - 1 rear panel, bottom
- **How supplied**
 - Preassembled, flat packaging

W	D	w	Model	Order-no.	UP
1200	800	1142	Linear	04.265.003.x	1 unit
1400	800	1342	Linear	04.265.004.x	1 unit
1600	800	1542	Linear	04.265.005.x	1 unit
1800	800	1742	Linear	04.265.006.x	1 unit
2000	800	1942	Linear	04.265.007.x	1 unit
1200	900	1142	Linear	04.265.013.x	1 unit
1400	900	1342	Linear	04.265.014.x	1 unit
1600	900	1542	Linear	04.265.015.x	1 unit
1800	900	1742	Linear	04.265.016.x	1 unit
2000	900	1942	Linear	04.265.017.x	1 unit



CON20120

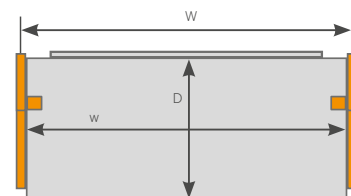

CON20121

Dimensions in mm: W = Width
H = Height
D = Depth
h = Installation height
d = Useful depth
L = Length

HU = Standard height unit, 1 HU = 44.45 mm
19" = 482.6 mm, (ideal for 19" components in acc. with DIN 41494)
UP = Unit of packaging
kg = Weight

Conversion: 1 inch = 25.4 mm
1 pound = 453.6 g

Replace „x“ with the number of your color choice

Knürr Elicon® VC Side Section Height-selectable

- Height-selectable in 20 mm increments from 640 to 760 mm
- Only usable in combination with Elicon VC Working Surfaces
- **Material / Finish**
 - Extruded aluminum profiles with
 - die-cast aluminum stabilizers and top section
 - Steel panel covers, powder-coated
- **Color**
 - RAL9006 White aluminium
- **Supply schedule**
 - 1 side section with cable duct covers
- **How supplied**
 - Completely preassembled

W	D	Model	Order-no.	UP
500	800	Side section	04.265.120.7	1 unit



CON20123

Knürr Elicon® VC Working Surfaces Linear

- Single table or linked
- Height-selectable in 20 mm increments from 640 to 760 mm
- Only usable in combination with Elicon VC Side Sections
- **Loading capacity**
 - 1200 N (static surface load)
- **Material / Finish**
 - Tabletop: Three-layer particle board FP/Y E1 variant, fire protection class B2
 - Tabletop cover: High pressure plastic laminate (HPL)
 - Edging: ABS
 - Stabilizer, cable trough and rear panel Steel panel, powder-coated
- **Color combination**
 - Tabletop:
 - .A RAL7035 Light gray or
 - .B Nelson Oak wood grain
 - Edging: Black gray
 - Sheet metal parts: RAL9006 White aluminium
- **Supply schedule**
 - 1 working surface with KVM technology module and 19" profiles
- **How supplied**
 - Preassembled, flat packaging

W	D	MODEL	Order-no.	UP
1200	800	Linear	04.265.103.x	1 unit
1400	800	Linear	04.265.104.x	1 unit
1600	800	Linear	04.265.105.x	1 unit
1800	800	Linear	04.265.106.x	1 unit
2000	800	Linear	04.265.107.x	1 unit

1200	900	Linear	04.265.113.x	1 unit
1400	900	Linear	04.265.114.x	1 unit
1600	900	Linear	04.265.115.x	1 unit
1800	900	Linear	04.265.116.x	1 unit
2000	900	Linear	04.265.117.x	1 unit



CON20120

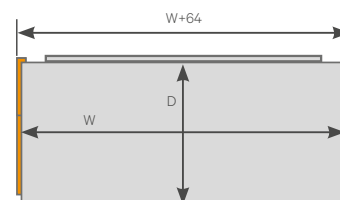

Please order the rear panel for foot areas separately for Elicon VC Working Surfaces!

Dimensions in mm: W = Width
H = Height
D = Depth
h = Installation height
d = Useful depth
L = Length

Conversion: 1 inch = 25,4 mm
1 pound = 453,6 g

HU = Standard height unit, 1 HU = 44,45 mm
19" = 482,6 mm, (ideal for 19" components in acc. with DIN 41494)
UP = Unit of packaging
kg = Weight
Replace „x“ with the number of your color choice

Knürr Elicon® VC Working Surfaces Corners

- Height-selectable in 20 mm increments from 640 to 760 mm
- Only usable in combination with Elicon VC Side Sections
- **Loading capacity**
 - 1200 N (static surface load)
- **Material / Finish**
 - Tabletop: Three-layer particle board FP/Y E1 variant, fire protection class B2
 - Tabletop cover: High pressure plastic laminate (HPL)
 - Edging: ABS
 - Stabilizer, cable trough and rear panel Steel panel, powder-coated
- **Color combination**
 - Tabletop:
 - .A RAL7035 Light gray or
 - .B Nelson Oak wood grain
 - Edging: Black gray
 - Sheet metal parts: RAL9006 White aluminium
- **Supply schedule**
 - 1 working surface with horizontal cable duct
- **How supplied**
 - Preassembled, flat packaging

D	Model	Order-no.	UP
800	90° corner	04.265.140.x	1 unit
800	90° wall corner	04.265.141.x	1 unit
900	90° corner	04.265.142.x	1 unit
900	90° wall corner	04.265.143.x	1 unit
800	45° corner	04.265.144.x	1 unit
900	45° corner	04.265.145.x	1 unit

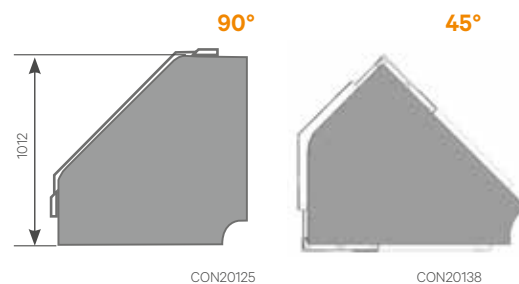
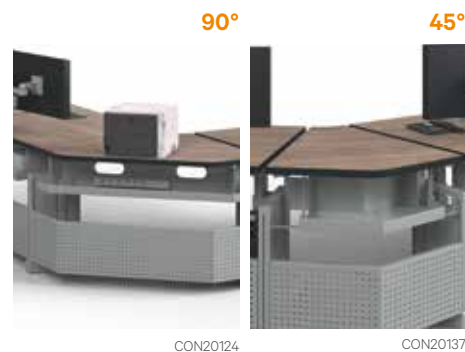

Knürr Elicon® VC Rear Panels Leg area

- **Material / Finish**
 - Steel panel, powder-coated
- **Color**
 - RAL9006 White aluminium
- **Supply schedule**
 - 1 rear panel with mounting material
- **How supplied**
 - Flat-packed kit

W	H	Model	Order-no.	UP
1200	300	Straight	04.265.153.7	1 unit
1400	300	Straight	04.265.154.7	1 unit
1600	300	Straight	04.265.155.7	1 unit
1800	300	Straight	04.265.156.7	1 unit
2000	300	Straight	04.265.157.7	1 unit
	300	90° corner	04.265.160.7	1 unit
	300	45° corner	04.265.159.7	1 unit

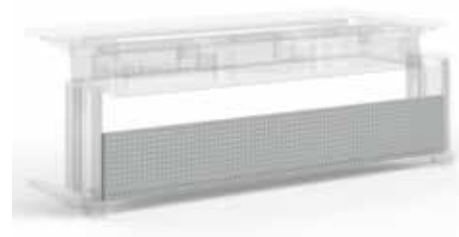

Technical Container

- Technical container for rear mounting on the Elicon VC/E system table.
- With removable perforated sheet metal cladding and cable entry options on both sides.
- Cables can be guided from the raised floor into the container and via cable chains towards the working level.
- **Usable dimensions**
 - Clear depth: 200 mm
 - Clear height: 550 mm
- **Material / Finish**
 - Body: Three-layer particle board
 - Sheet metal parts: RAL9006 White aluminium

W	Order-no.	UP
1200	04.265.243.7	1 unit
1400	04.265.244.7	1 unit
1600	04.265.245.7	1 unit.
1800	04.265.246.7	1 unit
2000	04.265.247.7	1 unit



Knürr Elicon® VC/VC-E Cover Set for cable duct

- **Material / Finish**
 - Steel panel, powder-coated
- **Color**
 - RAL9006 White aluminium

- **Supply schedule**
 - 1 rear panel
 - Mounting material

W	H	Model	Order-no.	UP
1200	200	Straight	04.265.163.7	1 unit
1400	200	Straight	04.265.164.7	1 unit
1600	200	Straight	04.265.165.7	1 unit
1800	200	Straight	04.265.166.7	1 unit
2000	200	Straight	04.265.167.7	1 unit
	200	90° corner	04.265.170.7	1 unit
	200	45° corner	04.265.174.7	1 unit



CON20127

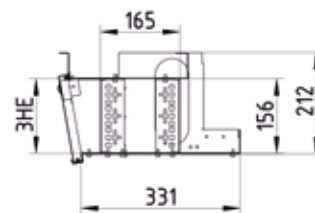

Sectional drawing of cable trough

Knürr Elicon® Computer Mount Lateral

- Left-hand, right-hand or dual mounting on vertical profile (both inside and outside) at any height
- WIDTH adjustable (165 to 265 mm)

- **Material / Finish**
 - Steel panel, anti-static, powder-coated structure.

- **Color**
 - RAL 9006 White aluminium

- **Loading capacity**
 - 250 N (static surface load)

- **Note**
 - The lowest mounting position corresponds to 80 mm (minimum ground clearance)
- **Supply schedule**
 - 1 computer support
 - Mounting material
- **How supplied**
 - Flat-packed kit

W	H	D	Order-no.	UP
			04.208.078.7	1 unit



CON20129

Knürr Elicon® VC/VC-E Adapter Bracket for PC Mount

- Required in addition to computer mount 04.208.078.7 for front-side mounting!

- **Color**
 - RAL 9006 White aluminium

Model	Order-no.	UP
For front-side mounting	04.265.179.7	1 unit



CON20130



Suitable monitor mounting accessories can be found from page 189

Dimensions in mm: W = Width
H = Height
D = Depth
h = Installation height
d = Useful depth
L = Length

Conversion: 1 inch = 25,4 mm
1 pound = 453,6 g

HU = Standard height unit, 1 HU = 44,45 mm
19" = 482,6 mm, (ideal for 19" components in acc. with DIN 41494)

UP = Unit of packaging
kg = Weight

Replace „x“ with the number of your color choice



Knürr Elicon® VC/VC-E - Horizontal cable duct

- Set with 2 cable trays for separate cable routing.
- Optimised for transverse cabling, e.g. when set up in rows or if there is no raised floor.
- Flexible positioning and easy assembly by hooking in the cable trays.
- **Material / Finish**
 - Galvanised steel,
 - Sheet steel powder coated
- **Supply schedule**
 - 2 horizontal cable trays
 - 2 mounting brackets with suspension lugs
 - Mounting material
- **How supplied**
 - as a set

* with Elicon® VC additionally requires the back panel in the foot area



Model	Order-no.	UP
Cable duct set horizontal W1200	04.265.253.7	1 unit
Cable duct set horizontal W1400	04.265.254.7	1 unit
Cable duct set horizontal W1600	04.265.255.7	1 unit
Cable duct set horizontal W1800	04.265.256.7	1 unit
Cable duct set horizontal W2000	04.265.257.7	1 unit

VC / VC-E monitor levels

- Optionally as height-fixed or electrically height-adjustable version (150mm adjustment range)
- With stable screw connection and additional clamping on the table top
- With functional and stable IM TFT rail and horizontal cable guide
- Single-sided energy chain for safe vertical cable routing
- **Supply schedule**
 - 1 monitor level with fixing material
 - 1 set of horizontal cable guides
 - 1 energy chain

Additionally for electrically height-adjustable version:

 - 1 control electronics and 1 control panel
- **How supplied**
 - In sets
- **Color**
 - RAL 9006 White aluminium



Type	Version	Order-no.	UP
Monitor level 1200 H-fix 1 Level	Heightfix	04.265.273.7	1 unit
Monitor level 1400 H-fix 1 Level	Heightfix	04.265.274.7	1 unit
Monitor level 1600 H-fix 1 Level	Heightfix	04.265.275.7	1 unit
Monitor level 1800 H-fix 1 Level	Heightfix	04.265.276.7	1 unit
Monitor level 2000 H-fix 1 Level	Heightfix	04.265.277.7	1 unit
Monitor level 1200 H-fix 2 Levels	Heightfix	04.265.283.7	1 unit
Monitor level 1400 H-fix 2 Levels	Heightfix	04.265.284.7	1 unit
Monitor level 1600 H-fix 2 Levels	Heightfix	04.265.285.7	1 unit
Monitor level 1800 H-fix 2 Levels	Heightfix	04.265.286.7	1 unit
Monitor level 2000 H-fix 2 Levels	Heightfix	04.265.287.7	1 unit
Monitor level 1200 H-A 1 Level	Height-adjustable	04.265.263.7	1 unit
Monitor level 1400 H-A 1 Level	Height-adjustable	04.265.264.7	1 unit
Monitor level 1600 H-A 1 Level	Height-adjustable	04.265.265.7	1 unit
Monitor level 1800 H-A 1 Level	Height-adjustable	04.265.266.7	1 unit
Monitor level 2000 H-A 1 Level	Height-adjustable	04.265.267.7	1 unit

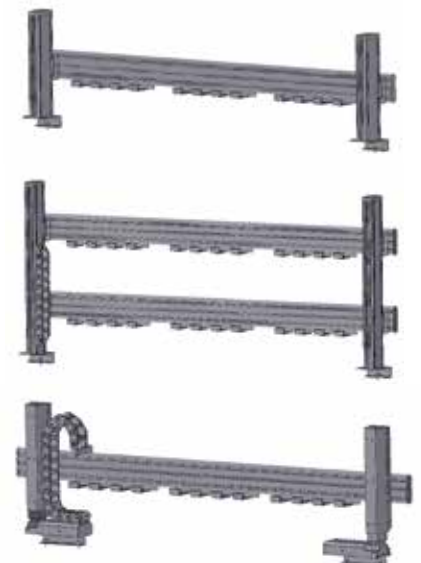

Accessories

Flat display mount, decorative panels, and integrated technology



Flat display mount

- Flat display mount for displays with VESA mount, 100 mm
 - With integrated cable duct
 - For mounting on Knürr IM function rail
 - Integrated quick-mount system
- **Material / Surface Type D-G**
 - Swivel arms: Die-cast aluminum, powdered RAL 9006 White aluminium
 - Adapter: Sheet steel powdered smooth, RAL9006 White aluminium
 - Covers on monitor arms: Plastic, clear
 - **Supply schedule**
 - 1x flat display mount
 - with height compensation plate
 - Fasteners
 - **How supplied**
 - In sets



Version	Height compensation plate	Load capacity	Order-no.	UP
Type IM short (130 mm)	•	15 kg	04.501.010.7	1 unit
Type IM medium (130+150 mm)	•	15 kg	04.501.011.7	1 unit
Type IM long (130+200 mm)	•	15 kg	04.501.012.7	1 unit
Type IM double (130+200+150 mm)	•	15 kg	04.501.013.7	1 unit

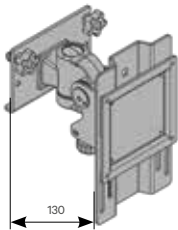

Flat display mount IM short

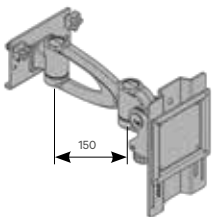

Flat display mount IM medium

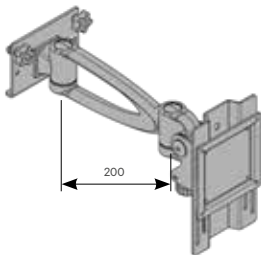

Flat display mount IM long

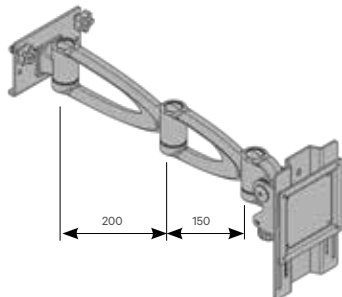

Flat display mount IM double

Monitor Mounts - Tube Mount System

- Flat screen mount for flat screens with VESA bracket 75 and 100 mm
- With integrated cable routing
- **Supply schedule**
 - 1x flat screen mount
 - Type E, F, G with accompanying height compensation plate
 - Mounting material
- **How supplied**
 - Flat-packed kit
- **Type D-G**
 - For mounting on Knürr top screen mounting columns for custom depth and height adjustment
 - Freely selectable mounting position on tabletop thanks to practical clamping system
- **Material/Surface Type D-G**
 - Swivel arms: die-cast aluminum, powder-coated, RAL 9006 White aluminium
 - Adapter: steel panel, powder-coated, smooth, RAL 9006 White aluminium
 - Covers on screen arms: plastic, clear

Model	Height compensation plate	Capacity	Order-no.	UP
Type D, for top screen mounting column (short)		15 kg	01.316.250.7	1 unit
Type E, for top screen mounting column (150 mm)	•	15 kg	01.316.251.7	1 unit
Type F, for top screen mounting column (200 mm)	•	15 kg	01.316.252.7	1 unit
Type G, for top screen mounting column (150x200 mm)	•	15 kg	01.316.253.7	1 unit
Tube mount for IM functional rail H400			01.316.254.9	1 unit
Tube mount for dual function rail H400			01.316.255.9	1 unit
Tube mount with clamp system (H400)			01.316.231.9	1 unit
Tube mount with clamp system (H700)			01.316.232.9	1 unit
Tube mount with screw fitting (H400)			01.316.233.9	1 unit
Tube mount with screw fitting (H700)			01.316.234.9	1 unit



Type D

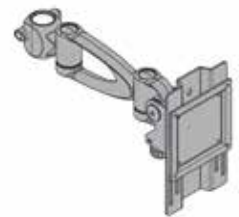

Type E

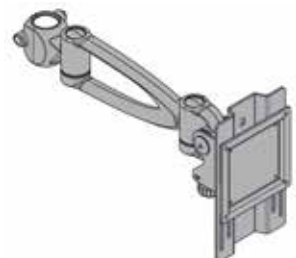

Type F

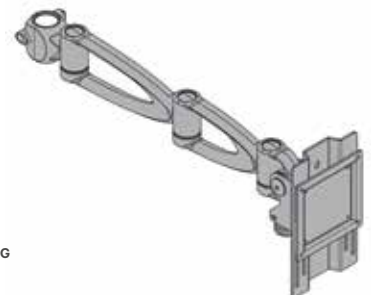

Type G

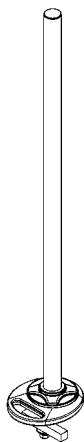

ACC20029

Pipe bracket for screw fitting

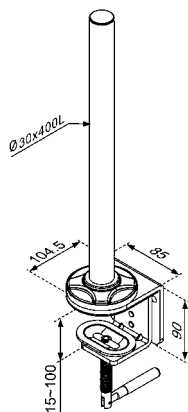

Pipe bracket with clamp mount

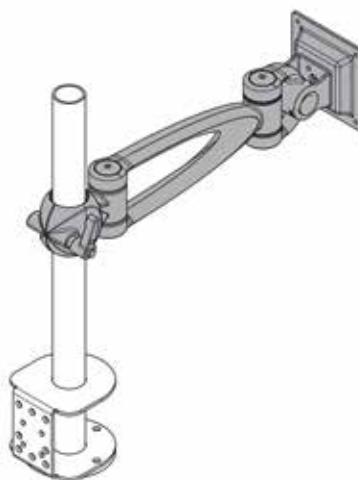

Pipe bracket for functional rail

VESA Adapter Plates

- For adapting VESA 100/200 and VESA 200/200 threaded connections to VESA 75 and VESA 100
 - Single adapter for monitors up to 12 kg
 - Double adapter for monitors up to 24 kg on 2 Vesa 75/100 holders
- How supplied**
 - Flat-packed kit
 - Material**
 - Sheet steel
 - Finish**
 - Powder-coated, RAL 9006, white aluminum



DAC20175



DAC20176

W	H	Model	Order-no.	UP
220	220	Single	01.316.244.9	1 unit
501	250	Double	01.316.245.9	1 unit

VESA Fast Change Plate

- Quick, tool-less monitor swap-out via spring balancer
 - For adapting VESA 75/100 threaded connections
 - With height adjustment holes
 - Low installation depth – only 15 mm
- Dimensions**
 - Width 130 mm
 - Height 170 mm
 - Depth 15 mm
 - Material**
 - Sheet steel
 - Finish**
 - Powder-coated, RAL 9006, white aluminum
- Supply schedule**
 - 1 adapter plate
 - Mounting material
 - How supplied**
 - Flat-packed kit

W	H	D	Order-no.	UP
130	170	15	01.316.239.9	1 unit



ERG00040

Touchscreen Mount inclinable

- Display holder with integrated and stepless tilt adjustment.
 - Inclination angle freely adjustable from 25° - 70° for individual and ergonomic operation of the touch display.
 - Simple and flexible positioning on the tabletop.
 - Suitable for displays with VESA 75/100 mount.
- Surface**
 - RAL 7021, dark grey
 - Supply schedule**
 - 1 Touchscreen mount
 - Mounting material
 - How supplied**
 - As Set
- Material**
 - Sheet steel, powder-coated



Type	Order-no.	UP
Touchscreen Mount inclinable	04.501.015.9	1 unit

Dimensions in mm: W = Width
 H = Height
 D = Depth
 h = Installation height
 d = Usable depth
 L = Length

HEA = electronically height adjustable
 HA = height-adjustable

UP = Unit of packaging
 kg = Weight

Conversion: 1 inch = 25,4 mm

Replace „x“ with the number of your color choice